

Single-row Angular Contact Ball Bearing

d 25-40 mm

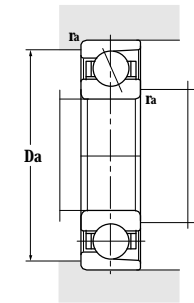
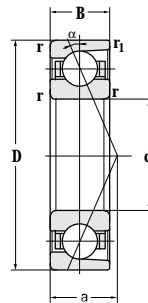

Principal dimensions					Basic load ratings		Limit speed ratings	
d	D	B	r	r <sub>1</sub>	C <sub>r</sub>	C <sub>or</sub>	Grease	Oil
mm					kN		r/min	
<b>25</b>	47	12	0.6	0.3	11.1	8.1	10000	15000
	52	15	1	1	15.9	9.6	10000	15000
	62	17	1.1	0.6	28.6	16.0	10000	15000
	62	17	1.1	0.6	24.7	14.0	9000	13000
<b>30</b>	55	13	1	1	14.3	10.0	1000	13000
	62	16	1.1	0.3	21.0	14.0	8500	12000
	72	19	1.1	0.6	31.8	21.0	8500	13000
	72	19	1.1	0.6	31.0	19.5	8000	11000
	72	19	1.1	0.6	33.6	18.0	8000	11000
<b>35</b>	72	17	1.1	1.1	30.5	20.7	8000	11000
	72	17	1.1	0.6	32.5	22.0	9000	12000
	72	17	1.1	0.6	27.0	19.0	8000	11000
	72	17	1.1	0.6	29.0	18.0	8000	11000
	80	21	1.5	0.6	40.3	26.0	8000	11000
<b>35</b>	80	21	1.5	0.6	39.0	25.0	7800	10500
	80	21	1.5	0.6	39.0	25.0	7500	10000
	80	21	1.5	0.6	39.0	25.0	6000	8000
	100	25	1.5	0.6	70.2	42.0	6300	8000
	100	25	1.5	0.6	70	42.0	6000	8000
<b>40</b>	68	15	1	1	20.5	15.9	8300	11000
	80	18	1.1	0.6	36.4	25.0	8000	11000
	80	18	1.1	0.6	36.4	25.0	6400	8800
	80	18	1.1	0.6	47.2	21.5	10000	15000
	80	18	1.1	0.6	34.5	24.1	7000	9500
	80	18	1.1	0.6	34.5	24.1	7000	9500
	90	23	1.5	0.6	46.8	32.5	7600	10000
	90	23	1.5	0.6	46.8	31.0	6000	8000
	90	23	1.5	0.6	46.8	30.0	6000	8000
	90	23	1.5	0.6	46.8	30.0	6000	8000

Designations	Contact points a	Abutment and fillet dimensions			Weight kg
		damax	Damax	ramax	
mm					
<b>7005AC</b>	22.8	25	43	0	0.0758
<b>7205C</b>	24	30.6	46	1	0.14
<b>7305C</b>	14.3	32	55	1	0.224
<b>7305BM</b>	27.2	32	55	1	0.277
<b>7006C</b>	12.2	35.5	49.5	1	0.118
<b>7206AC</b>	27	35.6	56	1	0.215
<b>7306C</b>	16.3	37	65	1	0.346
<b>7306ACM</b>	21.6	37	65	1	0.413
<b>7306BM</b>	30.9	37	65	1	0.371
<b>7207AC</b>	31	42	65	1	0.304
<b>7207C</b>	15.7	42	65	1	0.304
<b>7207BTN1</b>	31	42	65	1	0.285
<b>7207BM</b>	30.9	42	65	1	0.328
<b>7307C</b>	18.2	44	71	1.5	0.335
<b>7307ACM</b>	24.1	44	71	1.5	58.5
<b>7307BM</b>	35	44	71	1.5	0.551
<b>7307B</b>	35	44	71	1.5	0.481
<b>7407ACM</b>	28.3	44	91	1.5	1.14
<b>7407AC</b>	41	46	89	1.5	0.977
<b>7008C</b>	14.8	45.5	62.5	1	0.188
<b>7208C</b>	17	47	73	1	0.364
<b>B7208C</b>	17	47	73	1	0.383
<b>7208CTN1/HQ1</b>	17	47	73	1	0.312
<b>7208AC</b>	34	47	73	1	0.367
<b>7208ACM</b>	34	47	73	1	0.429
<b>7308C</b>	20.2	49	81	1.5	0.624
<b>7308ACM</b>	26.7	49	81	1.5	0.711
<b>7308B</b>	38.8	49	81	1.5	0.653
<b>7308BM</b>	38.8	49	81	1.5	0.711